

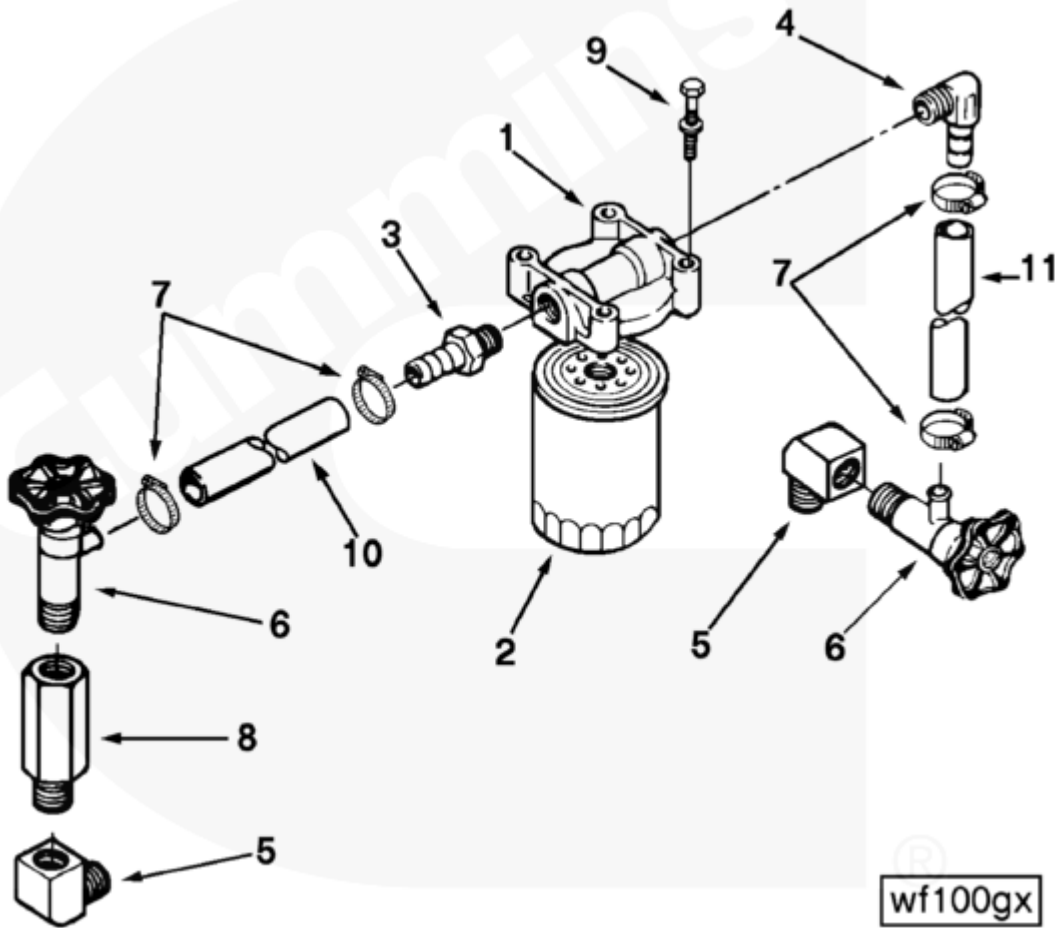

## Parts Catalog - Option Detail

Electronic Parts Catalog - Option Detail				
Option	Group	Graphic	Film Card	Date
WF1081	08.08	wf100gx	F	15-SEP-93
<b>Engines</b>	NH/NT 855, NT495, NT743, NTA855 N106			

©Cummins Inc



[SMALL](#) | [MEDIUM](#) | [LARGE](#)

Cart	Ref No	Part Number	Part Description	Required	Remarks
<a href="#">View My Cart</a>					
		<a href="#">WF1081</a>	Corrosion Resistor		
					Corrosion Resistor
					Spin-on corrosion resistor
					mounted on front port of

					pulse type exhaust manifold.
					Use with side opening
					thermostat housing and 90
					degree connection (3018764).
<input type="checkbox"/>	1	<a href="#">204163</a>	Corrosion Resistor Head	1	
<input type="checkbox"/>	2	<a href="#">3844234</a>	Corrosion Resistor Element	1	
<input type="checkbox"/>	3	<a href="#">179902</a>	Plain Hose Coupling	1	
<input type="checkbox"/>	4	<a href="#">179903</a>	Elbow Hose Coupling	1	
<input type="checkbox"/>	5	<a href="#">70470</a>	Plain Street Pipe Elbow	2	
<input type="checkbox"/>	6	<a href="#">179901</a>	Shut-Off Valve	2	
<input type="checkbox"/>	7	<a href="#">179904</a>	Hose Clamp	4	3/8 - 7/8 in.
<input type="checkbox"/>	8	<a href="#">180221</a>	Plain Pipe Adapter	1	
<input type="checkbox"/>	9	<a href="#">3010596</a>	Captive Washer Cap Screw	4	3/8 - 16 x 1 1/4 in.
<input type="checkbox"/>	10	<a href="#">3062299</a>	Plain Hose	1	
<input type="checkbox"/>	11	<a href="#">3062304</a>	Plain Hose	1	
<input type="checkbox"/>		<a href="#">3826824</a>	Decal	1	